

Pressure plate assembly

flanged permanently fitted version



Note:

- Flanged permanently mounted pressure plates are smooth.
- Interchangeable pressure plates have rib-like ridges all around the cylindrical edge.

Remove damaged pressure plate.

Caution: Do not bend the tight spot behind the spindle ball head (e.g. clamp the pressure plate on the flange in a vice and carefully move the spindle back and forth so that the flanging expands and the pressure plate detaches from the ball head)

Assembly of a new pressure plate

- 1 Clamp the wood (A) and angle iron (B) in the vice.
- 2 Insert the ball head (C) into the new pressure plate as shown.
- 3 Use a hammer and punch (or similar) to crimp the edge as shown below. Do not strike too hard to maintain the mobility of the pressure plate on the spindle ball head.

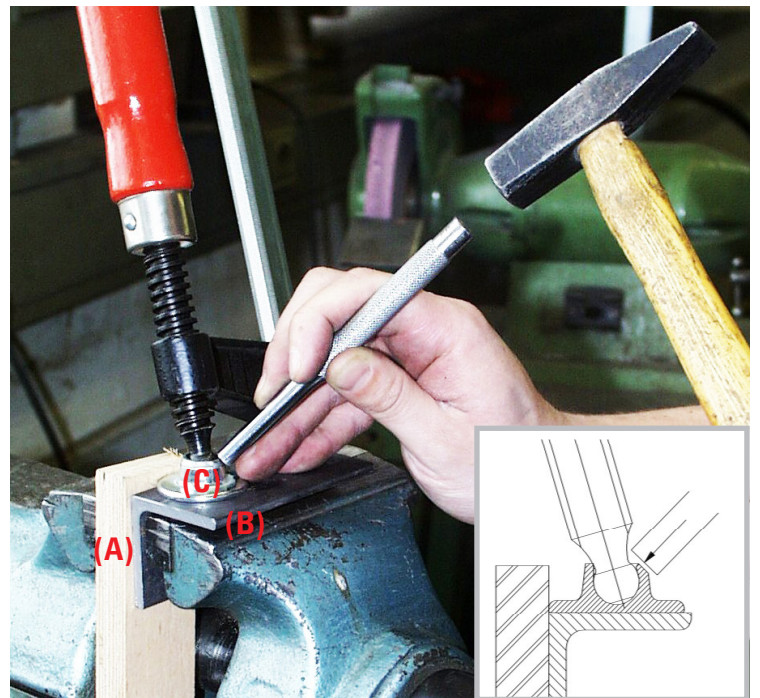

Sequence of hammer blows:

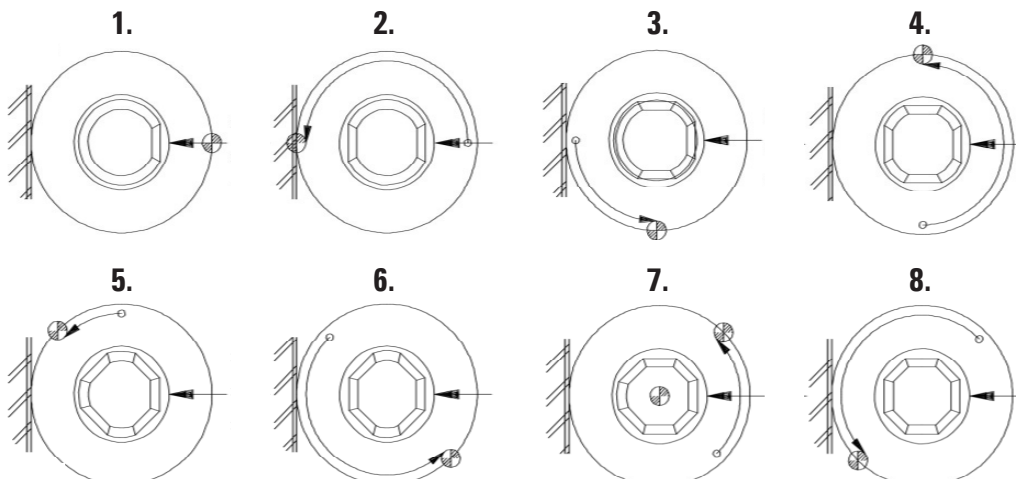

Pressure plate assembly

interchangeable design



Note:

- Flanged permanently mounted pressure plates are smooth.
- **Interchangeable pressure plates have rib-like ridges all around the cylindrical edge.**

Remove damaged pressure plate.

Caution: Do not bend the tight spot behind the spindle ball head

Disassembly of the fitted interchangeable pressure plate

- 1** Turn the spindle all the way back until the pressure plate runs against the sliding bracket. Make sure that the pressure plate is exactly flat against the sliding bracket.
- 2** Continue to rotate vigorously until the pressure plate “pops” off the ball (until the spring-loaded retainer in the pressure plate is released). If it is difficult to move, start again and check the system!

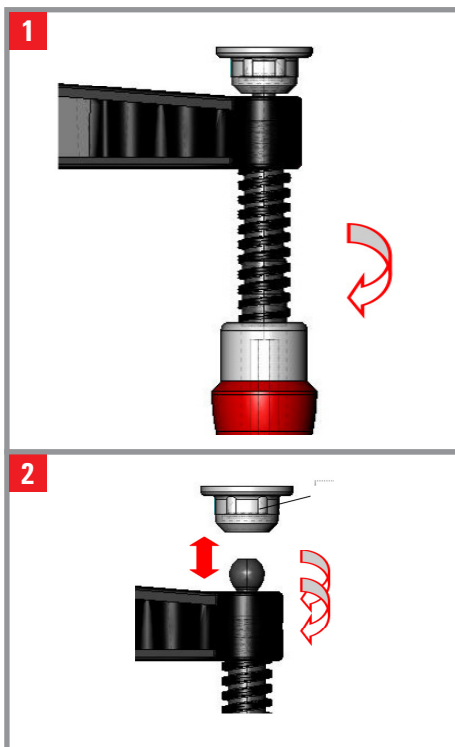

Assembly of a new pressure plate

- 3** Place the new interchangeable pressure plate on the upper clamping arm and rotate the spindle against the pressure plate until the ball head of the spindle snaps into the pressure plate.
- 4** Check the manoeuvrability of the pressure plate on the ball head.

